



Compass House, Fulham  
SW6

GARTON JONES.COM



# Compass House, Fulham , SW6

GARTON JONES.COM

13 Park Street  
Chelsea Creek  
London  
SW6 2FS

Sales +44 (0) 20 7824 7090  
paul@gartonjones.com  
www.gartonjones.com

## £550 Per Week

Highly desirable 2nd floor unfurnished Manhattan apartment 430sqft (40sqm) located in Compass House. The stylish apartment offers a bright open plan living space overlooking the communal gardens, modern kitchen with integrated appliances, sliding door providing access and privacy for the bedroom area and bathroom. Chelsea Creek is situated in one of London's most elegant dockside developments, which combines luxurious central London living whilst overlooking tranquil waterways, tree lined avenues and landscape gardens. Residents benefit from 24 Hour Concierge, Spa and fitness suite with Swimming pool and. King's Road and Chelsea Harbour are easily accessible and Imperial Wharf Station is just a few minutes' walk.

5 weeks security deposit  
12-month contract

Council Tax — London Borough of  
Hammersmith & Fulham — Band D  
EPC (C) 80

- Manhattan Apartment
- 417sqft (38sqm)
- 2nd Floor with Lift
- Unfurnished
- Open Plan Living Space
- Modern Kitchen with Integrated Appliances
- Residents Spa — Swimming pool & Gymnasium
- Walking Distance to Imperial Wharf Underground Station
- Recently Redecorated
- Overlooking the Communal Garden



EPC certificate available on request.

## Compass House

Approximate Gross Internal Area = 417 sq ft / 38.8 sq m

GARTON JONES  
LONDON

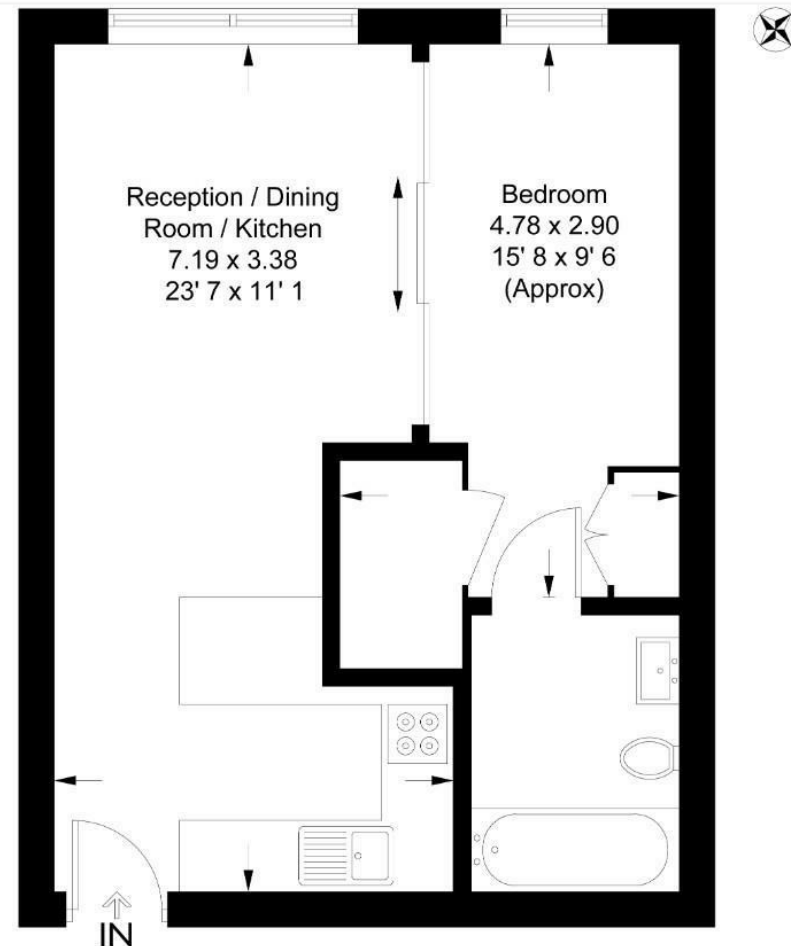

## Second Floor

This plan is not to scale and must be used as layout guidance only. All measurements and areas are approximate and should not be relied upon to provide accurate information. This plan must not be relied upon when making property valuations, design considerations or any other such relevant decisions. We accept no responsibility or liability (whether in contract, tort or otherwise) in relation to any loss whatsoever arising from or in connection with any use of this plan or the adequacy, accuracy or completeness of it or any information within it.



